

Plumbing & Sanitary



Stainless Steel Wall Faced Slop Hopper - Made to Order



M-SH-WFP (P TRAP)

M-SH-WFS (S TRAP)

- No ligature points
- Suitable for use with an in wall cistern
- Available in P trap or S trap
- Radius edges
- Satin finish
- Concealed fixings
- 2mm 304 grade stainless steel
- In stock and available for immediate delivery

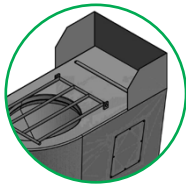

- Also available with a 150mm high shroud

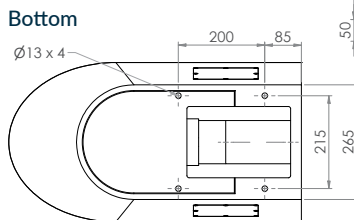
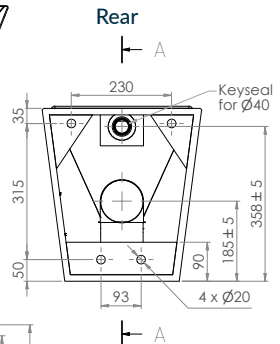
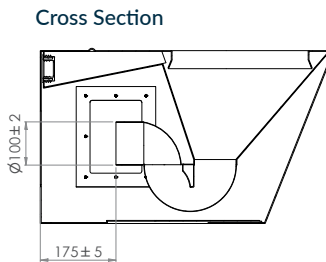
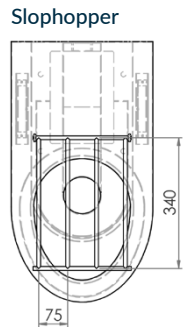
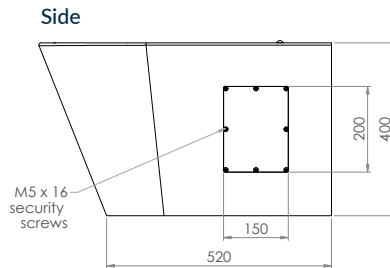
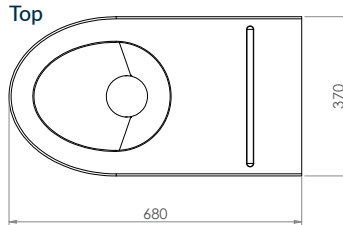

Please Note: S trap pan is supplied with a separate pan bend. Set out dimension 130mm + or - 5mm.

Refer to warranty for exclusions.

3monkeez.com.au