

# Storage & Hardware

## Adjustable Feet

FH-26  
FH-27



Zinc Die-Cast Chrome Plated Adjustable Hex Foot - Square Tube

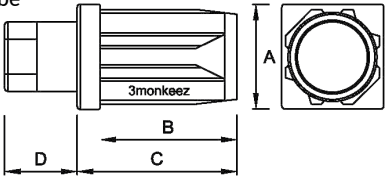

PRODUCT CODE	A	B	C	D	ADJ. HEIGHT
FH-26	25	32	37	10	25
FH-27	32	43	50	23	33

FH-29  
FH-30



Zinc Die-Cast Chrome Plated Adjustable Flanged Foot - Square Tube

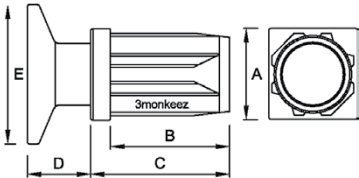

PRODUCT CODE	A	B	C	D	E	ADJ. HEIGHT
FH-29	25	32	37	10	30	25
FH-30	32	43	50	23	50	33

FH-31  
FH-32



304 Grade Stainless Steel Clad Adjustable Hex Foot - Round Tube

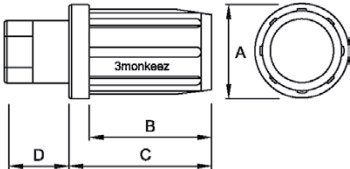

PRODUCT CODE	A	B	C	D	ADJ. HEIGHT
FH-31	38 *	43	51	24	33
FH-32	50 *	46	56	28	35

\* This represents tube size. To fit tube of 1.2mm or 1.6mm wall thickness. All measurements in mm.