

Wall Faced Close Coupled Toilet Pan

WC-SSWFCCP (P TRAP)

WC-SSWFCCS (S TRAP)

- No ligature points and concealed fixings
- Available in P trap or S trap
- Radius edges
- Inbuilt dual flush cistern
- Adjustable inlet and outlet valves for setting the required flush volume
- 2mm 304 grade satin finish stainless steel
- In stock and available for immediate delivery
- See compatibility chart on seats data sheets



Top

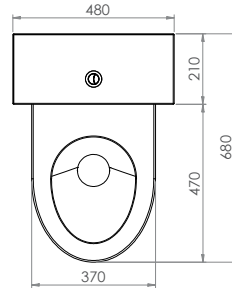

Front

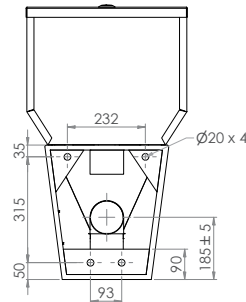

Side

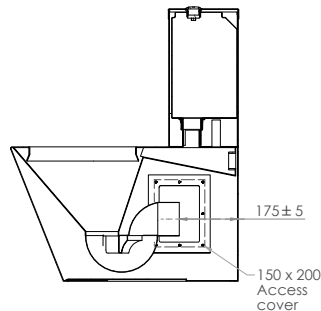

Please Note: S trap pan is supplied with a separate pan bend. Set out dimension 130mm + or - 5mm. Mini stop to be 150mm-350mm FFL and 100mm out from centre of pan.