

Storage & Hardware

Stainless Steel Adjustable Leg & Mounting Plate



FH-46-S/S

(O/A Height 124mm - 153mm)

FH-46-Z/P

(O/A Height 124mm - 153mm)

FH-47-S/S

(O/A Height 150mm - 177mm)

FH-47-Z/P

(O/A Height 150mm - 177mm)

FH-48-S/S

(O/A Height 198mm - 227mm)

FH-48-Z/P

(O/A Height 198mm - 227mm)

FH-49-S/S

(O/A Height 249mm - 277mm)

FH-49-Z/P

(O/A Height 249mm - 277mm)



FH-50 (Stainless Steel)

FH-51 (Zinc Plated)



Adjustable Leg - Round Tube

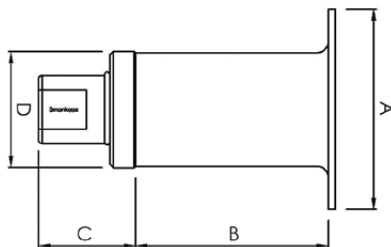

PRODUCT CODE	A	B	C	D	MOUNTING PLATE
FH-46-S/S	88	85	36	50	FH-50
FH-46-Z/P	88	85	36	50	FH-51
FH-47-S/S	88	110	36	50	FH-50
FH-47-Z/P	88	110	36	50	FH-51
FH-48-S/S	88	160	36	50	FH-50
FH-48-Z/P	88	160	36	50	FH-51
FH-49-S/S	88	210	36	50	FH-50
FH-49-Z/P	88	210	36	50	FH-51

Mounting Plate

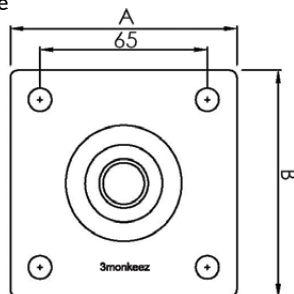

PRODUCT CODE	A	B	THICKNESS	HOLE	# OF HOLES
FH-50	88	88	3	9	4
FH-51	88	88	3	9	4

S/S = Stainless Steel Z/P = Zinc Plated

All measurements in mm.