

### Wall Mount Trough

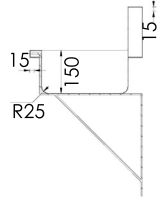

1. Quantity - \_\_\_\_\_
2. Length - \_\_\_\_\_ mm
3. Outlet Position
  - Centre
  - Custom \_\_\_\_\_ mm (to the centre of the outlet from the left)
4. Stainless Steel Grade
  - 304
  - 316
5. Radius to
  - External Only
  - External and Internal
6. Splashback (extra cost) -
  - Standard (150mm)
  - Custom, height - \_\_\_\_\_ mm
7. Freestanding Frame (extra cost)
  - No
  - Yes, height - \_\_\_\_\_ mm
8. Plug and Waste (extra cost)
  - No
  - Yes
9. Tap Holes (optional)
  - No
  - Yes, number of tap holes - \_\_\_\_\_

Tap Hole Size
 
  - 20mm
  - 22.5mm
  - 25mm
  - 30mm
  - 35mm
10. Pre Plumbing (extra cost)
  - No
  - Yes

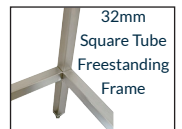

**Recommended tap hole spacing: Adults – 600mm and children\* – 450mm**

Please draw tap holes clearly, showing dimensions for spacing



\* Lever handle taps are recommended for children 8 years and under.

Pre fabricated items are non returnable and non refundable  
 All MTO products have a lead time - please confirm prior to ordering  
 Email - orders@3monkeeZ.com.au

Company:	Purchase Order Number:
Name:	Date:
Signature:	Phone Number: