

“Congratulations on your purchase of a premium commercial tapware product from 3monkeez. Our products have been tested and are manufactured to AS/NZS 3718.”

### PRODUCT MODEL

T-3MSSIWM

### IMPORTANT INFORMATION



Notes: Please follow the below procedures. If these are not followed it can impact the life of some components and void warranties.

- It is recommended that this product be installed by a licensed plumber.
- ALL pipework must be thoroughly flushed to remove any debris prior to installation as foreign materials may cause damage to internal parts and affect performance.
- If the unit is replacing an existing unit please ensure the water supply is turned off and remove any existing water from the lines.
- The tapware may come partially assembled. This is for packing purposes only.
- Mixer body must be installed square to the wall/tile face, to ensure the cover plate sits flush.
- To avoid damaging the cover plate, do not remove the plastic protective sleeves until installations is complete

### INSTALLATION INSTRUCTIONS

#### Step 1

Secure the mixer body onto a mounting plate or noggin in the wall using the washers and screws provided through the holes in the body of the mixer. Ensure the Hot (H) inlet is to the left and the Cold (C) inlet to the right. The outlet should be vertically upwards.

#### Step 2

Connect hot water to the hot side (left) and the cold to the cold side (right). Connect outlet to shower or bath. Check all connections for leaks.

#### Step 3

Once sheeting and tiling are complete fit the rubber seal onto the cover plate and slide the cover plate onto the diverter sleeve until firmly against the wall/tile

#### Step 4

Fit the handle taking care that it is pushed down completely; tighten the screw inside the cover button hole using the allen key provided.

#### Step 5

Place the cover button back into the hole

*\*Once installation is complete; turn the water supply on to test the functionality of the unit. Check for leaks.*



## REPLACING THE CARTRIDGE

- Turn off the hot and cold water supplies
- Carefully remove the indicator plug, loosen the screw using the allen key provided and remove the handle
- Unscrew the cartridge cap being careful not to damage the cover plate.
- Unscrew the retaining nut and remove the old cartridge
- Ensure the inside of the mixer is clean and free from dirt
- Check the seal is in position in the base of the new cartridge, then fit into the mixer body. Ensuring the lugs on the base of the new cartridge fit into the holes in the mixer body
- Screw on retaining nut, Note: Nut should be tightened to a torque of 10Nm
- Replace cartridge cap and tighten by hand
- Fit handle back in place ensuring the handle is pushed completely down. Tighten the screw using the allen key provided.
- Place the cover button back in position, red to left, blue to the right

## IMPORTANT - PRESSURE AND TEMPERATURE REQUIREMENTS

- Hot and cold water inlet pressures should be equal.
- Working pressure range; 150–1000kPa.
- **RECOMMENDED WORKING PRESSURE IS 500kPa**
- **PLEASE NOTE** – New Regulation – 500kPa maximum operating pressure at any outlet within a building (Ref. AS/NZS 3500.1-2003, Clause 3.3.4).
- Maximum hot water temperature 80°C.

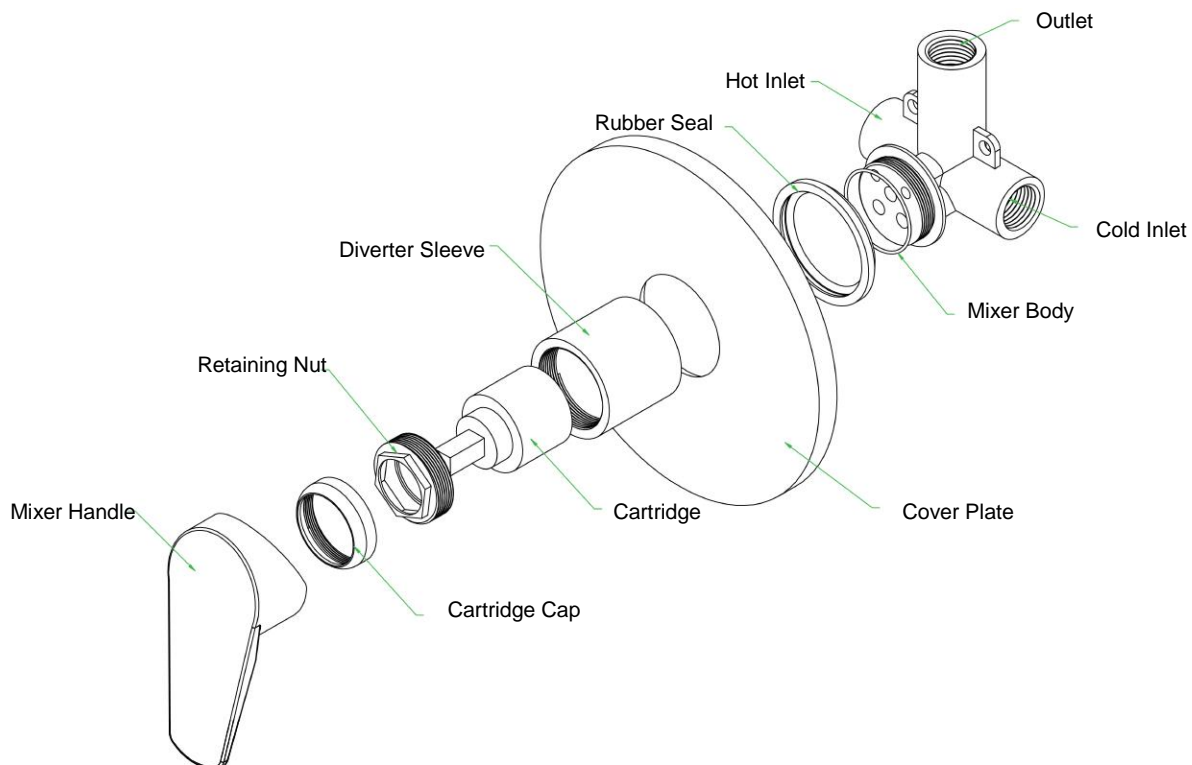

al

## PACKING LIST

1 X IN WALL MIXER BODY, 1 X COVER PLATE, 1 X MIXER HANDLE, 1 x PACKET OF FIXING SCREWS AND WALL LUGS, 1 X INSTALLATION INSTRUCTIONS, 1 X WARRANTY CERTIFICATE