

Congratulations! You have just purchased one of the premium products from 3monkeez commercial tapware range which has been manufactured to Australian Standard AS/NZS3718.

SCOPE OF APPLICATION**T-3MSS-KBS5****IMPORTANT INFORMATION**

Note: Please follow the below procedures. If the below procedures are not followed it may impact the life of some components and void warranties.

- Product must be installed by a qualified plumber in accordance with the Plumbing Code of Australia (PCA), AS/NZS3500 and the Manufacturer's instructions
- All pipework must be thoroughly flushed to remove any debris prior to installation as foreign materials may cause damage to internal parts and affect performance
- Aerator insert housing must be tightened to prevent removal by hand for all units
- If the unit is replacing an existing unit please ensure the water supply is turned off

INSTALLATION INSTRUCTIONS**Step 1**

Flush the water supply line to clear any debris. Remove the unit from the packaging and check that all parts are included inside the box against the packing list.

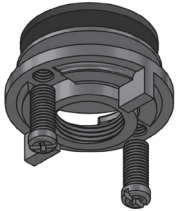
Figure 1**Step 2**

Remove the aerator from the gooseneck spout and place aside. Remove the stainless steel backing nut, stainless steel washer and rubber washer from the thread (parts shown in Figure 1). Ensure the rubber in the base of the spout remains in the recess underneath (part shown in Figure 2).

Step 3

Fit the spout through your pre drilled 22mm tap hole.

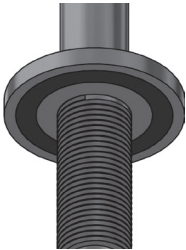
Figure 2**Step 4**

Fit the rubber washer, then the stainless steel washer, then the stainless steel backing nut back on the thread from underneath your tap landing/bench.

Step 5

Using a phillips head screwdriver, tighten both screws on the stainless steel backing nut to secure the spout in place.

Step 6

Once the unit has been installed, connect the water supply to the gooseneck spout, turn on water supply and test the functionality of the gooseneck spout. Check for any leaks. Once checked, screw the aerator back onto the gooseneck spout.

TO CLEAN THE AERATOR

Periodically clean the aerator, approximately every 4-6 months, depending on use.

- Unscrew the aerator
- Rinse out any debris that may have built up
- Screw the aerator back on and continue normal use



TECHNICAL INFORMATION

Gooseneck Spout Inlet Connection	1/2" MI BSP Thread
Sensor Tap Outlet	Neoperl Aerator
Working Pressure Range	30kPa - 500kPa
Flow Rate	6.0LPM
Recommended Operating Temperature	5-50 Degrees Celcius
Finish	Satin Stainless Steel

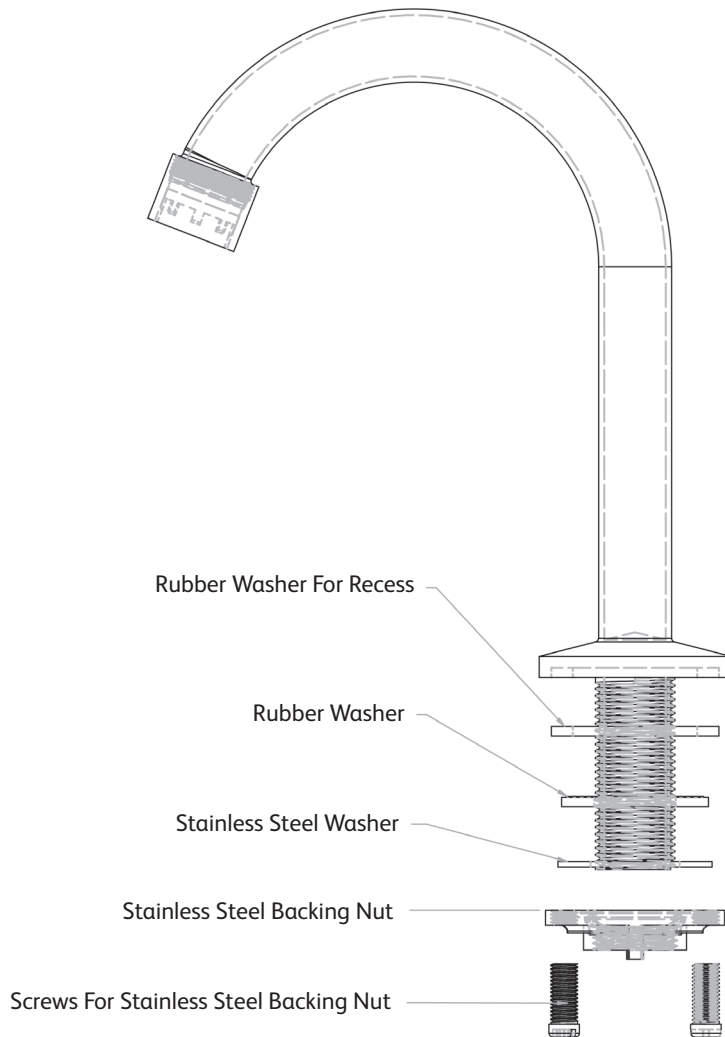

STAINLESS STEEL MAINTENANCE AND CLEANING INSTRUCTIONS

Stainless steel products must be cleaned on a regular basis to maintain the ability to resist corrosion. The surface of stainless steel has a protective layer that creates a protective shield against oxidation; which makes it durable and long lasting. Protecting this layer is important to ensure the longevity of this product.

Cleaning stainless steel products is an easy task when done regularly:

- Clear away all debris from the surface with a microfiber cloth or soft sponge; don't use abrasive materials.
- Once cleared of debris, go over the surface with a food safe stainless steel cleaner, bicarb soda or mild detergent and water. The best chemicals for stainless steel contain alkaline and don't have chloride in them.
- To remove stubborn stains, use a good quality stainless steel cleaner and non abrasive cloth.
- Rinse thoroughly with clean fresh water.
- Towel dry the product with a soft dry absorbent cloth after cleaning and use.
- Once dry, use a food safe stainless steel or metal polish. Follow the grain of the metal to ensure the best results and avoid damage.
- Always keep the product clean and dry when not in use.
- Don't leave anything citric on the product as it can etch the surface over time.
- Don't leave soaps and other cleaners on your stainless steel product overnight or damp sponges/cloths on of the product when not in use.

TIP - Cleaning your stainless steel equipment after each use as above will ensure the product remains in good condition.