

Congratulations! You have just purchased one of the premium products from 3monkeez commercial tapware range which has been manufactured to Australian Standard AS/NZS3718.

SCOPE OF APPLICATION**T-3MSS-CSTSB - Cleaners Sink Spout Bracket**

Also included in cleaners sink tap kits, **T-3MCSKIT-C08** and **T-3MCSKIT-E08**

The cleaners sink spout support bracket is a stainless steel wire cable with a wall attachment plate and a machined collar which clamps around the cleaners sink spout.

The collar also includes a wire hook to allow a bucket to hang underneath while being filled.

The bracket prevents the spout from bending under the weight of the bucket

IMPORTANT INFORMATION

Note: Please follow the below procedures. If the below procedures are not followed it may impact the life of some components and void warranties.

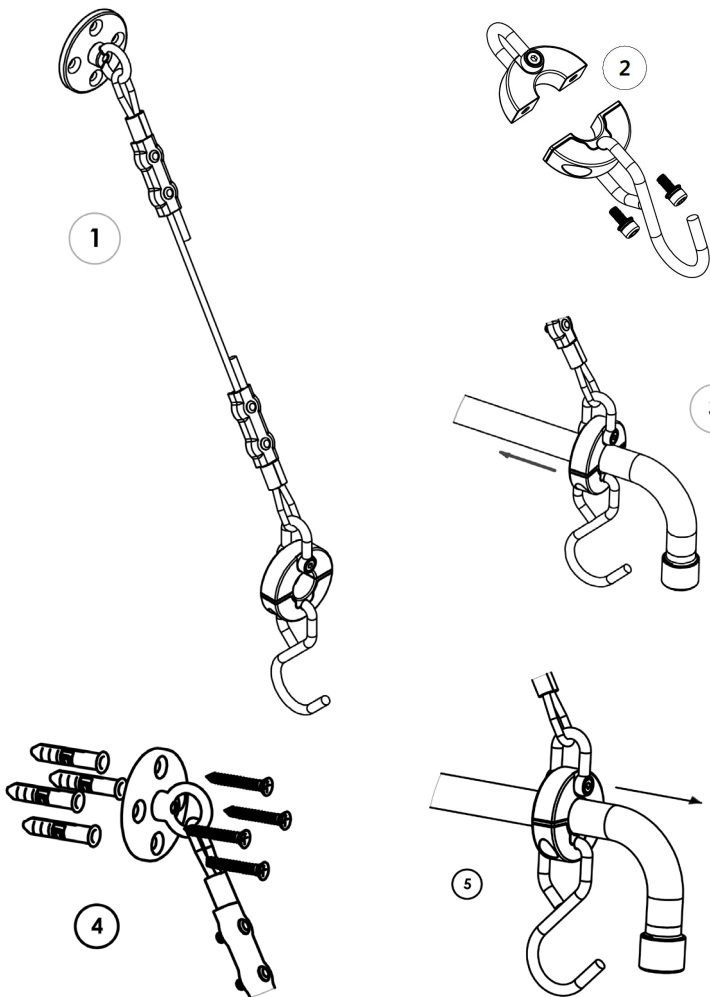
INSTALLATION INSTRUCTIONS**Step 1**

Open packaging and check contents.

The package should include;

- a) The complete support bracket assembly, including the wall mount plate, the collar and hook assembly.
- b) A separate pack containing;
 - 4 x wall anchors.
 - 4 x stainless steel screws.

Step 2

Using a 4mm hex (Allen) key, unscrew the two screws holding the two parts of the collar assembly together.

Step 3

Assemble the collar on to the spout. Determine the final position and then move it back towards the wall about 20mm. Lightly tighten.

Step 4

Mark a vertical line on the wall above the centre of the spout. Pull the wall mounting plate onto the line to a point where the cable is reasonably tight. Mark the screw holes and drill 8mm holes for the wall anchors provided, or pilot holes if screwing directly into the wall. Screw the mounting plate to the wall.

Step 5

Loosen the collar holding the hook and pull outwards until the support cable is fully tensioned. Tighten the screws on the collar to lock into position.

Step 6

If required, the cable length may be adjusted by loosening the cable clamps and re-positioning the cable.

The 3monkeez cleaners sink tap bracket is designed to support the weight of a bucket being filled with water. It is not designed to carry heavier weights and may result in damage or injury if used for other purposes. Please observe Safe Work Australia codes of practice for manual handling.