

# SCRAPTRAP™

SINK WASTE ARRESTOR FOR USE IN COMMERCIAL & DOMESTIC SINKS

Sydney Water PA No: 2006-372  
3monkeez  
Ph: 02 9627 6111  
www.3monkeez.com.au

## MODEL : SSBW

### RECOMMENDED INSTALLATION PROCEDURE

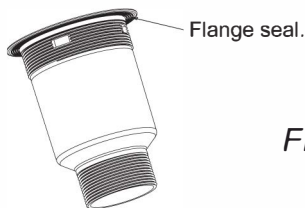

FIG1

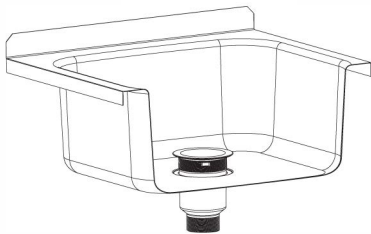

FIG2

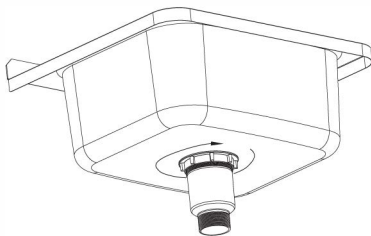

FIG3

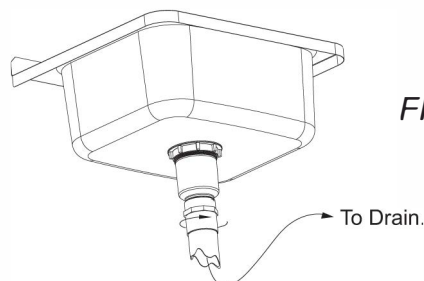

FIG4

a) Make sure both top and bottom surfaces around the outlet of the sink are clean

b) Remove the plug and basket from the body of the Scraptrap. Un-screw flange and disregard the flange seal

c) Apply a bead of silicone to the recess of the outlet and around the flange of the Scraptrap. Place body through 90mm sink outlet as shown in Fig 2.

d) Ensure rubber seal is in place between locking nut and the bottom of the sink. Tighten locking nut until a water tight seal is achieved as shown in Fig3.

e) Connect 2" trap to AS/NZS 3500 Standard.

f) Place basket back inside body so that the lip sits on top of the ridge approximately 20mm down from the top.